

# PROJECT DESCRIPTION:

28 QCELLS Q.PEAK DUO BLK-G10+ (365W) ROOF MOUNTED SOLAR PHOTOVOLTAIC MODULES  
 SYSTEM SIZE: 10.22KWDC STC  
 SYSTEM SIZE: 8.12KWAC

## SYSTEM SUMMARY

28 QCELLS Q.PEAK DUO BLK-G10+ (365W) MODULES  
 28 ENPHASE IQ8PLUS-72-2-US INVERTER (240V)

DESIGN CRITERIA	
WIND SPEED	107
EXPOSURE CATEGORY	B
RISK CATEGORY	II
MOUNTING METHOD	ROOF MOUNT
GROUND SNOW LOAD	0

## CODE COMPLIANCE

ALL WORK SHALL COMPLY WITH ALL STATE AND LOCAL CODES, ORDINANCES AND ANY OTHER REGULATING AUTHORITIES WHICH HAVE AUTHORITY OVER ANY PORTION OF THE WORK.

### AHJ CODES

2019 CALIFORNIA BUILDING CODE  
 2019 CALIFORNIA MECHANICAL CODE  
 2019 CALIFORNIA PLUMBING CODE  
 2019 CALIFORNIA ELECTRICAL CODE  
 2019 CALIFORNIA FIRE CODE  
 2019 CALIFORNIA ENERGY CODE  
 2019 CALIFORNIA RESIDENTIAL BUILDING CODE  
 2019 CALIFORNIA GREEN BUILDING STANDARDS CODE

## GENERAL INSTALLATION NOTES

1. INSTALLER SHALL ASSUME FULL RESPONSIBILITY AND LIABILITY FOR COMPLIANCE WITH REGULATIONS PER FEDERAL OSHA AND LOCAL REGULATIONS PERTAINING TO WORK PRACTICES, PROTECTION OF WORKERS AND VISITORS TO THE SITE.
2. INSTALLER SHALL VERIFY ALL EXISTING CONDITIONS AND DIMENSIONS AT SITE BEFORE COMMENCING WORK.
3. CONTRACTOR SHALL FURNISH ALL MATERIAL EXCEPT AS SPECIFIED IN THE CONTRACT AND/OR THESE DRAWINGS.
4. ALL MATERIALS SHALL BE IN NEW AND UNUSED CONDITION.
5. MANUFACTURER'S MATERIAL EQUIPMENT, ETC. SHALL BE INSTALLED PER MANUFACTURER'S RECOMMENDATIONS AND INSTRUCTIONS.
6. THE INSTALLER SHALL BECOME FAMILIAR WITH ALL UTILITY AS-BUILT PLANS AND THE LOCATIONS OF ALL EXISTING UTILITIES, STRUCTURES, PAVEMENT OR IMPROVEMENTS.
7. CONTRACTOR SHALL VERIFY EXISTING CONDITIONS AND NOTIFY THE OWNER OF DISCREPANCIES REQUIRING FURTHER CLARIFICATION BEFORE PROCEEDING WITH THE WORKS.
8. INSTALL ALL ASPECTS OF THIS PROJECT IN ACCORDANCE WITH THE SPECIFICATIONS AND AS NOTED ON DRAWINGS ISSUED FOR CONSTRUCTION.
9. CONDUCTORS EXPOSED TO SUNLIGHT SHALL BE LISTED AS SUNLIGHT RESISTANT PER 310.0(D)
10. WORKING CLEARANCES AROUND THE EXISTING AND NEW ELECTRICAL EQUIPMENT WILL BE MAINTAINED IN ACCORDANCE WITH NEC 110.26
11. EXACT CONDUIT RUN LOCATIONS SUBJECT TO CHANGE
12. ROOF PENETRATIONS ARE SEALED.
13. INVERTER IS LISTED TO UL-1741 "UTILITY INTERACTIVE"

## SHEET INDEX

PV-0	COVER SHEET
PV-1	PLOT PLAN
PV-2	ARRAY PLAN
PV-3	ATTACHMENT DETAIL
PV-4	ELECTRICAL LINE DIAGRAM
PV-4.1	WIRE CALCULATIONS
PV-5	LABELS & PLACARD
PV-6.1	EQUIPMENT SPECIFICATION-1
PV-6.2	EQUIPMENT SPECIFICATION-2
PV-6.3	EQUIPMENT SPECIFICATION-3

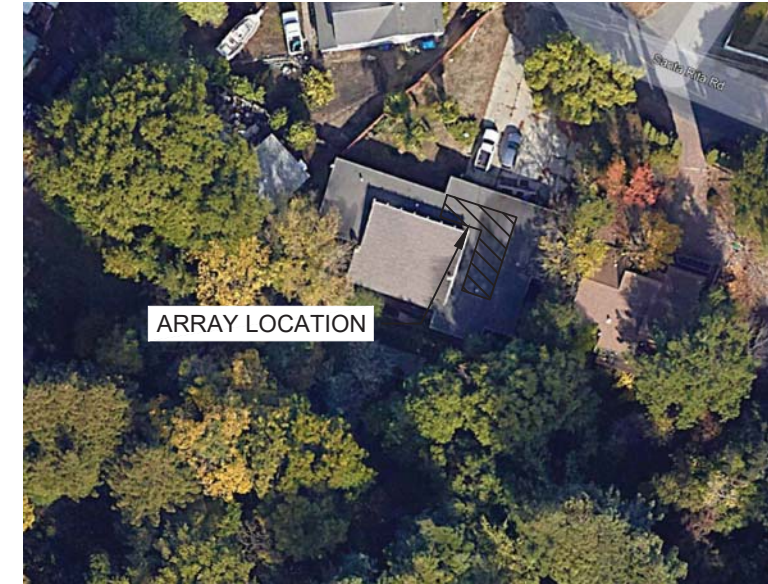

ARRAY LOCATION

1 HOUSE PHOTO

PV-0

SCALE: NTS

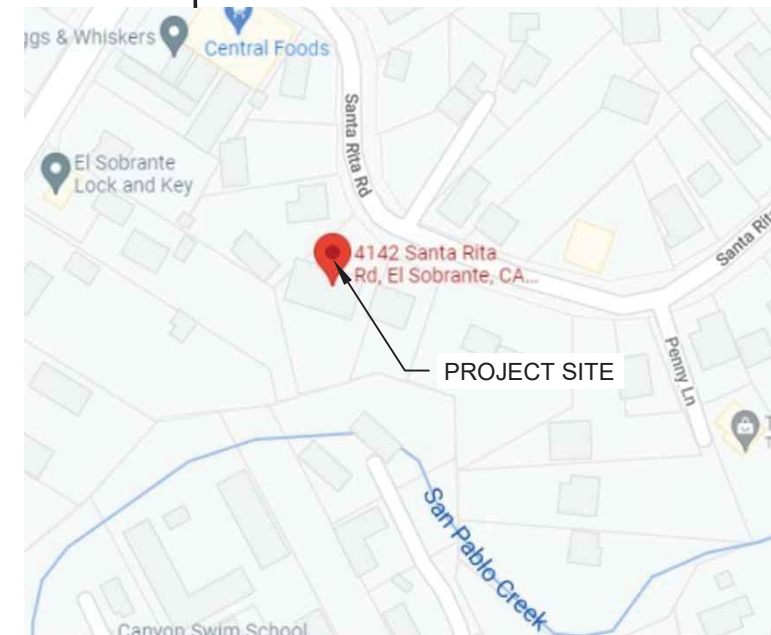

PROJECT SITE

2 VICINITY MAP

PV-0

SCALE: NTS

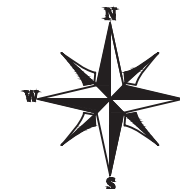

REVISIONS	REV	DATE	DESCRIPTION
	01	25-JUL-22	100% DESIGN
	02	02-AUG-22	CLIENT COMMENTS
	03	12-SEP-22	CLIENT COMMENTS
	04	27-OCT-22	CLIENT COMMENTS
	05	03-FEB-23	MODULE CHANGED

Signature with Seal

## CUSTOMER INFORMATION

**APRIL BELL**

4142 SANTA RITA RD.,  
 EL SOBRANTE, CA 94803 USA  
 JURISDICTION: CONTRA COSTA, COUNTY OF

SHEET NAME

**COVER SHEET**

SHEET SIZE

**ANSI B  
 11" X 17"**

SHEET NUMBER

**PV-0**

**SYSTEM SUMMARY**

28 QCELLS Q.PEAK DUO BLK-G10+ (365W) MODULES  
 28 ENPHASE IQ8PLUS-72-2-US INVERTER (240V)  
 SYSTEM SIZE: 10.22KWDC 8.12KWAC

05

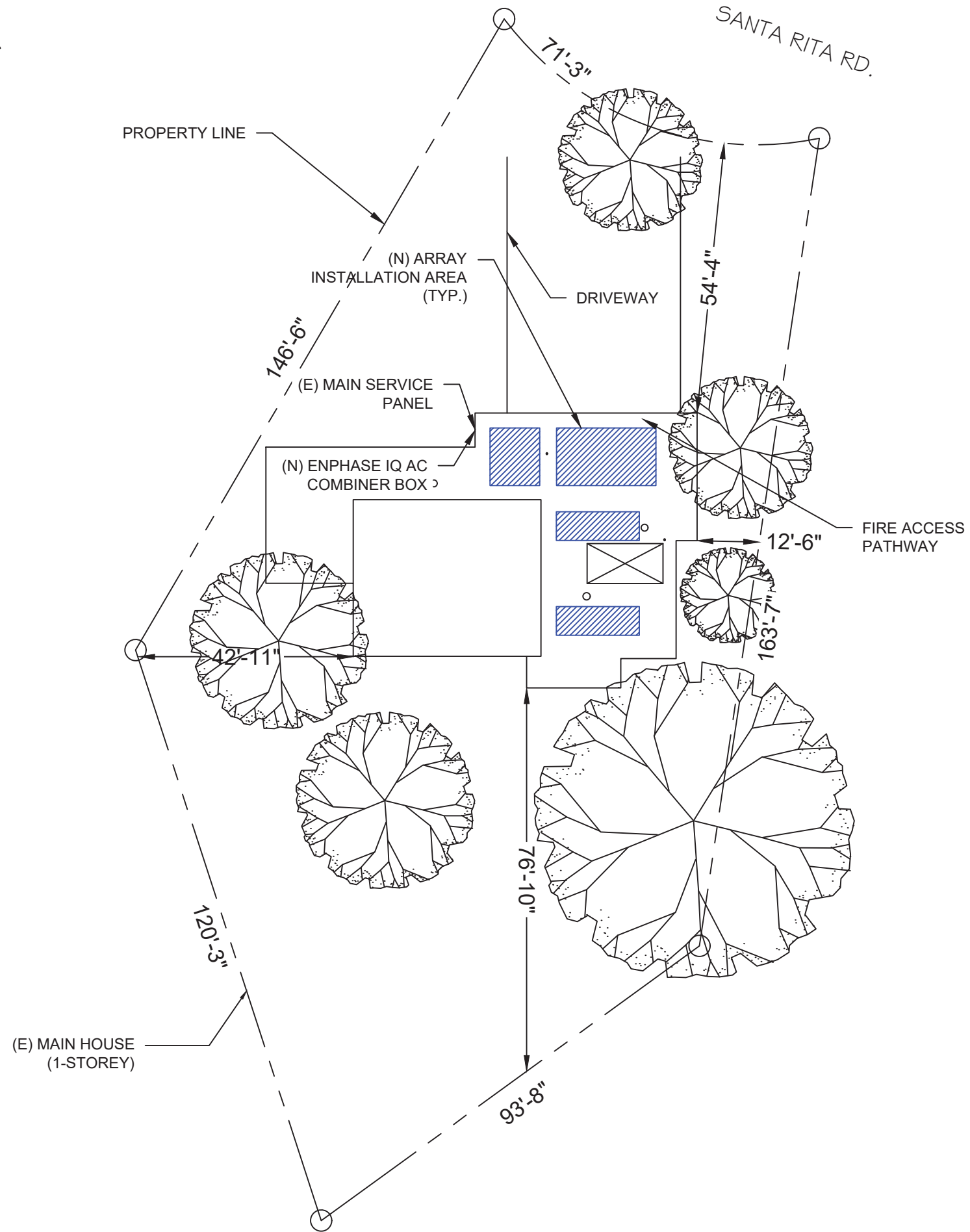

REVISIONS	DESCRIPTION	DATE	REV
	100% DESIGN	25-JUL-22	01
	CLIENT COMMENTS	02-AUG-22	02
	CLIENT COMMENTS	12-SEP-22	03
	CLIENT COMMENTS	27-OCT-22	04
	MODULE CHANGED	03-FEB-23	05

Signature with Seal

**CUSTOMER INFORMATION**

**APRIL BELL**

4142 SANTA RITA RD.,  
 EL SOBRANTE, CA 94803 USA  
 JURISDICTION: CONTRA COSTA, COUNTY OF

SHEET NAME  
 PLOT PLAN

SHEET SIZE  
 ANSI B  
 11" X 17"

SHEET NUMBER  
 PV-1

**SYSTEM SUMMARY**  
 28 QCELLS Q.PEAK DUO BLK-G10+ (365W) MODULES  
 28 ENPHASE IQ8PLUS-72-2-US INVERTER (240V)  
 SYSTEM SIZE: 10.22KWDC 8.12KWAC

<b>ROOF AREA</b>	3,697 SQ FT ROOF		
<b>SOLAR PANEL AREA</b>	19.31 SQ FT EACH	28 PANELS	540.68 SQ FT ARRAY
<b>SOLAR % OF ROOF AREA</b>	14.62%	14.62% < 33% ROOF COVERAGE	

MOUNTING PLANE	TILT	TRUE AZIMUTH	ROOF TYPE	STORY	# OF MODULES
ROOF 1	0°	189°	TPO	1-STORY	28

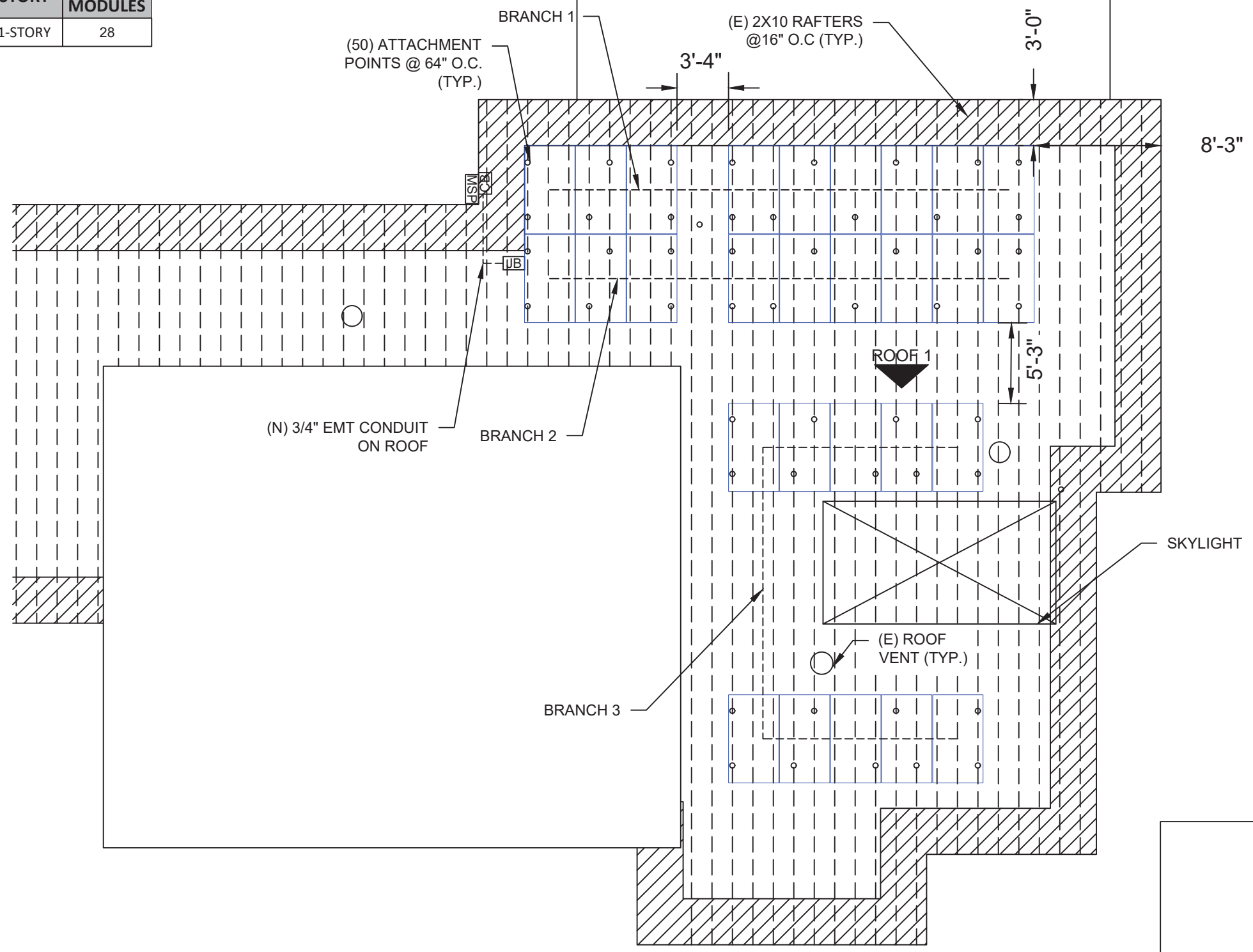

**LEGEND**

- MSP - MAIN SERVICE PANEL
- CB - ENPHASE COMBINER BOX
- JB - JUNCTION BOX
- - BRANCH
- FIRE SETBACKS



REVISIONS	REV	DATE	DESCRIPTION
	01	25-JUL-22	100% DESIGN
	02	02-AUG-22	CLIENT COMMENTS
	03	12-SEP-22	CLIENT COMMENTS
	04	27-OCT-22	CLIENT COMMENTS
	05	03-FEB-23	MODULE CHANGED

Signature with Seal

**CUSTOMER INFORMATION**  
**APRIL BELL**  
 4142 SANTA RITA RD.,  
 EL SOBRANTE, CA 94803 USA  
 JURISDICTION: CONTRA COSTA, COUNTY OF

SHEET NAME  
**ARRAY PLAN**

SHEET SIZE  
**ANSI B  
 11" X 17"**

SHEET NUMBER  
**PV-2**

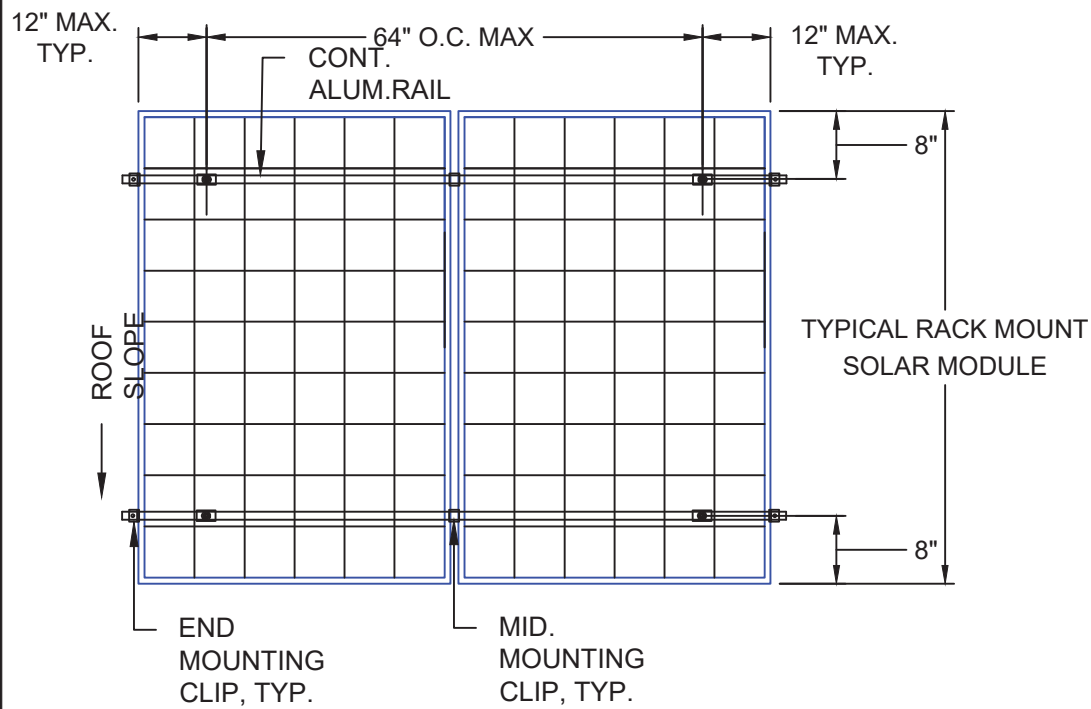

**1** TYPICAL RACK MOUNT LAYOUT

PV-3

SCALE: NTS

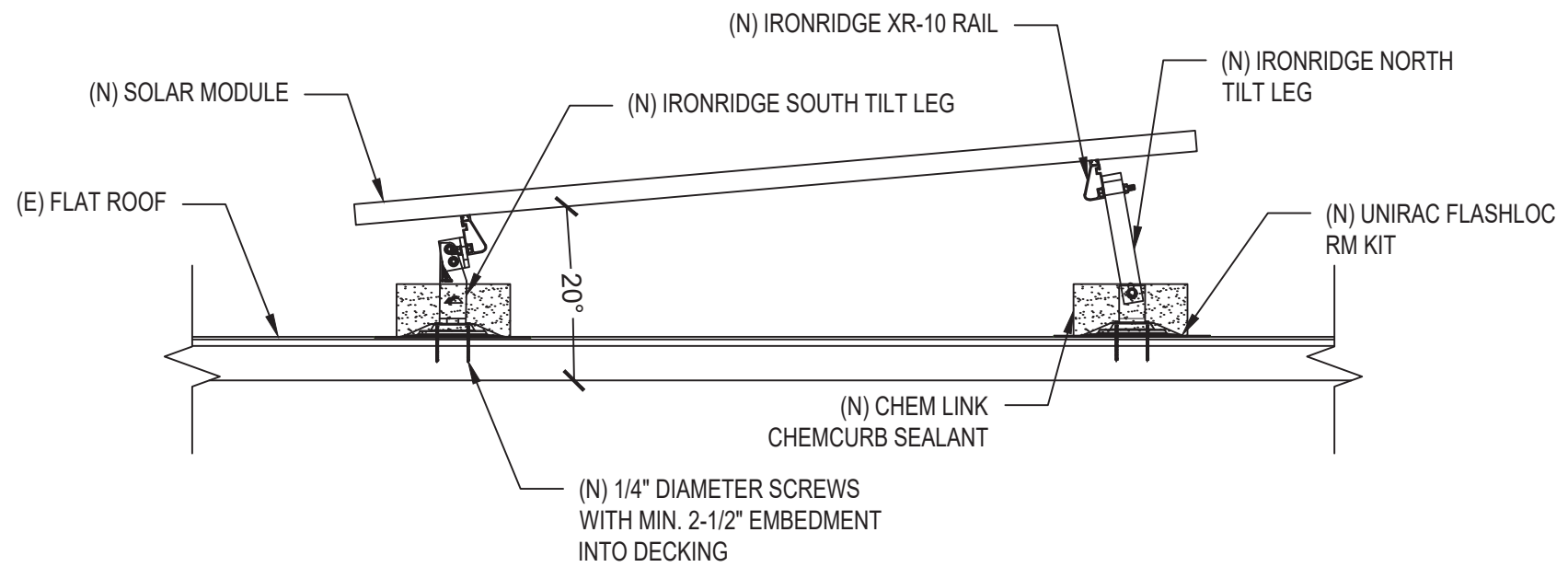

**2** TYPICAL RACK MOUNT LAYOUT

PV-3

SCALE: NTS

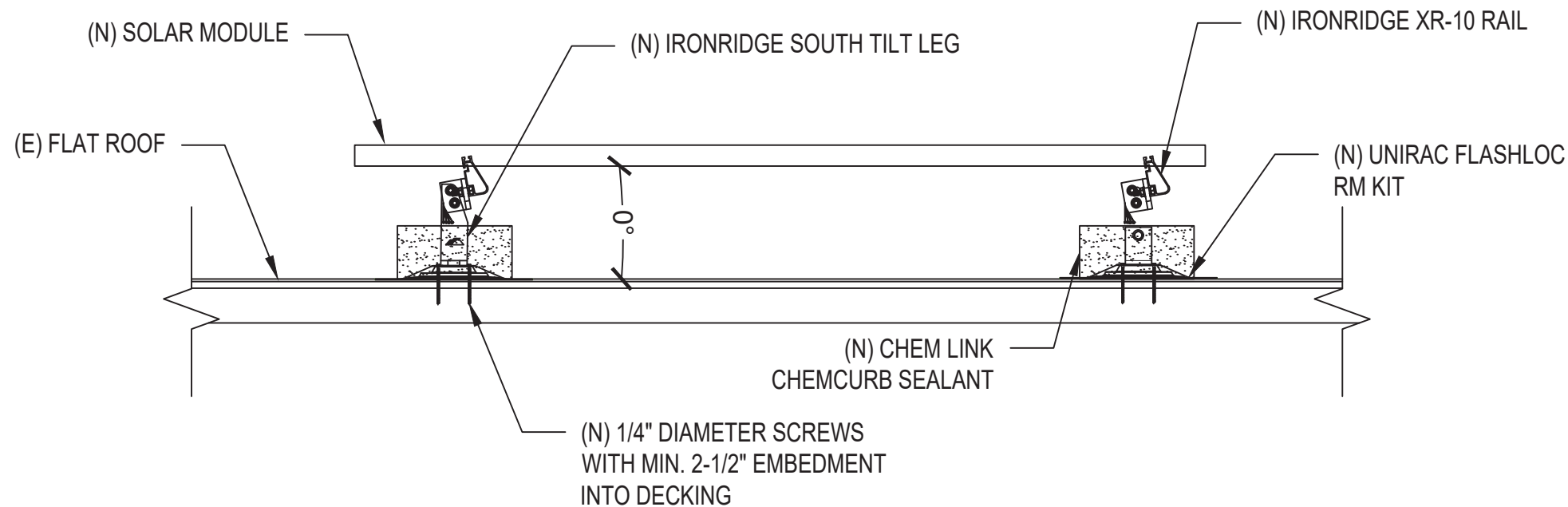

**3** TYPICAL RACK MOUNT LAYOUT

PV-3

SCALE: NTS

REVISIONS	REV	DATE	DESCRIPTION
	01	25-JUL-22	100% DESIGN
	02	02-AUG-22	CLIENT COMMENTS
	03	12-SEP-22	CLIENT COMMENTS
	04	27-OCT-22	CLIENT COMMENTS
	05	03-FEB-23	MODULE CHANGED

Signature with Seal

CUSTOMER INFORMATION

**APRIL BELL**

4142 SANTA RITA RD.,  
EL SOBRANTE, CA 94803 USA

JURISDICTION: CONTRA COSTA, COUNTY OF

SHEET NAME  
**ATTACHMENT  
DETAIL**

SHEET SIZE  
**ANSI B  
11" X 17"**

SHEET NUMBER

**PV-3**

**SYSTEM SUMMARY**  
 28 QCELLS Q.PEAK DUO BLK-G10+ (365W) MODULES  
 28 ENPHASE IQ8PLUS-72-2-US INVERTER (240V)  
 SYSTEM SIZE: 10.22KWDC 8.12KWAC

05

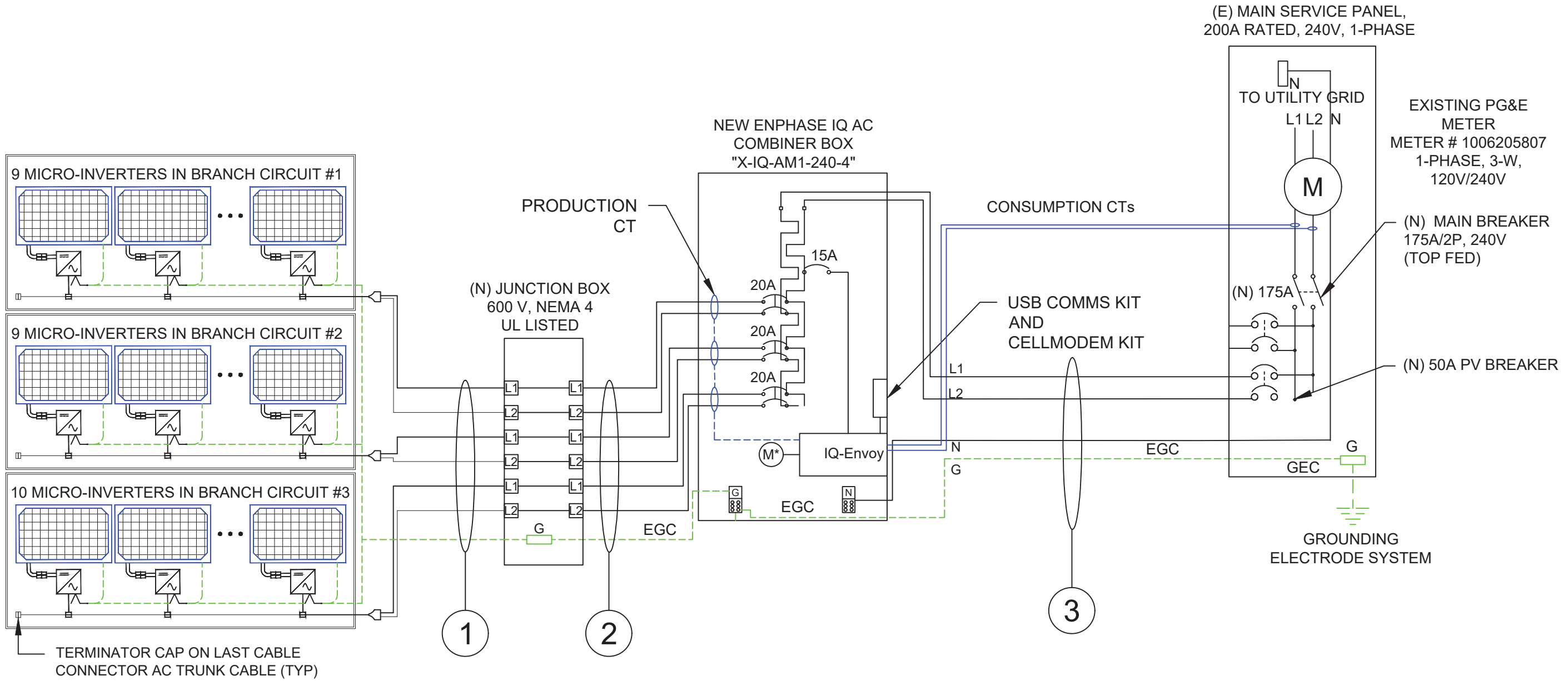

REVISIONS	DESCRIPTION	DATE	REV
	100% DESIGN	25-JUL-22	01
	CLIENT COMMENTS	02-AUG-22	02
	CLIENT COMMENTS	12-SEP-22	03
	CLIENT COMMENTS	27-OCT-22	04
	MODULE CHANGED	03-FEB-23	05

Signature with Seal

CUSTOMER INFORMATION  
**APRIL BELL**  
 4142 SANTA RITA RD.,  
 EL SOBRANTE, CA 94803 USA  
 JURISDICTION: CONTRA COSTA, COUNTY OF

SHEET NAME  
**ELECTRICAL LINE DIAGRAM**

SHEET SIZE  
**ANSI B  
 11" X 17"**

SHEET NUMBER  
**PV-4**

ENPHASE TRUNK CABLE TO BE ATTACHED TO RAIL MIN. 3-1/2" ABOVE ROOF SURFACE

CONDUIT TO BE MIN. 7/8" ABOVE ROOF SURFACE

PV BREAKER TO BE INSTALLED AT THE END OF THE BUS

WIRE TAG #	WIRE FROM - -	CONDUIT	WIRE QTY	WIRE GAUGE:	WIRE TYPE ENPHASE TRUNK CABLE INCLUDES #12 GROUND	TEMP RATING:	WIRE AMP	TEMP DE-RATE:	CONDUIT FILL:	WIRE OCP:	TERMINAL 75°C RATING:	INVERTER QTY:	NOC:	NEC:	STRING AMPS	GRND SIZE	GRND WIRE TYPE
①	ARRAY TO JUNCTION BOX	PV WIRE	2	#12	TRUNK CABLE	90°C	30A x	1.00 x	NA	= 30.00A	25A	10	x 1.21A x 1.25	= 15.13A	#6	BARE COPPER	
②	JUNCTION BOX TO COMBINER PANEL	3/4" EMT	7	#10	THWN-2	90°C	40A x	0.96 x	0.8	= 30.72A	35A	10	x 1.21A x 1.25	= 15.13A	#10	THWN-2	
③	COMBINER PANEL TO MSP	3/4" EMT	4	#8	THWN-2	90°C	55A x	0.96 x	1.00	= 52.8A	50A	28	x 1.21A x 1.25	= 42.35A	#10	THWN-2	

Rooftop conductor ampacities designed in compliance with art. 690.8, Tables 310.15(B)(2)(a), 310.15(B)(3)(a), 310.15(B)(3)(c), 310.15(B)(16), Chapter 9 Table 4, 5, & 9. Location specific temperature obtained from ASHRAE data tables

RECORD LOW TEMP	1°C
AMBIENT TEMP (HIGH TEMP 2%)	25°C
CONDUIT HEIGHT	7/8" MIN.
CONDUCTOR TEMPERATURE RATE	90°C

WIRE TAG #	CONDUIT FILL	OCPD
①	N/A	N/A
②	70%	20A
③	60%	50A

**120% RULE**

BUS BAR RATING X 120% - MAIN BREAKER RATING  
= MAX. PV OCPD

(200A x 120%) - 175 = 65A

REVISIONS	DESCRIPTION	DATE	REV
	100% DESIGN	25-JUL-22	01
CLIENT COMMENTS	02-AUG-22	02	
CLIENT COMMENTS	12-SEP-22	03	
CLIENT COMMENTS	27-OCT-22	04	
MODULE CHANGED	03-FEB-23	05	

Signature with Seal

CUSTOMER INFORMATION

**APRIL BELL**  
 4142 SANTA RITA RD.,  
 EL SOBRANTE, CA 94803 USA  
 JURISDICTION: CONTRA COSTA, COUNTY OF

SHEET NAME  
**WIRE CALCULATIONS**

SHEET SIZE  
**ANSI B 11" X 17"**

SHEET NUMBER  
**PV-4.1**

**WARNING**  
**INVERTER OUTPUT CONNECTION DO NOT RELOCATE THIS OVERCURRENT DEVICE**

LABEL LOCATION:  
 POINT OF INTERCONNECTION  
 (PER CODE: CEC 705.12(B)[Not required if panelboard is rated not less than sum of ampere ratings of all overcurrent devices supplying it])

**SOLAR DISCONNECT**

LABEL LOCATION:  
 DISCONNECT, POINT OF INTERCONNECTION  
 (PER CODE: CEC690.13(B))

**CAUTION: SOLAR ELECTRIC SYSTEM CONNECTED**

LABEL LOCATION:  
 WEATHER RESISTANT MATERIAL, DURABLE ADHESIVE, UL969 AS STANDARD TO WEATHER RATING (UL LISTING OF MARKINGS NOT REQUIRED), MIN 3/8" LETTER HEIGHT ARIAL OR SIMILAR FONT NON-BOLD, PLACED WITHIN THE MAIN SERVICE DISCONNECT, PLACED ON THE OUTSIDE OF THE COVER WHEN DISCONNECT IS OPERABLE WITH SERVICE PANEL CLOSED. (PER CODE: CEC690.15, 690.13(B))

**CAUTION: SOLAR CIRCUIT**

LABEL LOCATION:  
 MARKINGS PLACED ON ALL INTERIOR AND EXTERIOR DC/AC CONDUIT, RACEWAYS, ENCLOSURES, AND CABLE ASSEMBLIES AT LEAST EVERY 10 FT, AT TURNS AND ABOVE/BELOW PENETRATIONS AND ALL COMBINER/JUNCTION BOXES.

**WARNING DUAL POWER SOURCE SECOND SOURCE IS PHOTOVOLTAIC SYSTEM**

LABEL LOCATION:  
 POINT OF INTERCONNECTION  
 (PER CODE: CEC 705.12(D)(4))

**WARNING**  
**ELECTRIC SHOCK HAZARD**  
 DO NOT TOUCH TERMINALS  
 TERMINALS ON BOTH LINE AND LOAD SIDES MAY BE ENERGIZED IN THE OPEN POSITION

LABEL LOCATION:  
 AC DISCONNECT, POINT OF INTERCONNECTION  
 (PER CODE: CEC 690.17(B))

**WARNING**  
**ELECTRIC SHOCK HAZARD**  
 IF A GROUND FAULT IS INDICATED NORMALLY GROUNDED CONDUCTORS MAY BE UNGROUNDED AND ENERGIZED

LABEL LOCATION:  
 DC DISCONNECT, INVERTER  
 (PER CODE: CEC 690.15)  
 [To be used when inverter is ungrounded]

**WARNING**  
**ELECTRIC SHOCK HAZARD**  
 THE DC CONDUCTORS OF THIS PHOTOVOLTAIC SYSTEM ARE UNGROUNDED AND MAY BE ENERGIZED

LABEL LOCATION:  
 AC DISCONNECT, POINT OF INTERCONNECTION

**PHOTOVOLTAIC SYSTEM EQUIPPED WITH RAPID SHUTDOWN**

LABEL LOCATION:  
 WEATHER RESISTANT MATERIAL, DURABLE PLAQUE, UL969 AS STANDARD TO WEATHER RATING (UL LISTING OF MARKINGS NOT REQUIRED), MIN 3/8" LETTER HEIGHT ARIAL OR SIMILAR FONT NON-BOLD, PLACED WITHIN THE MAIN SERVICE DISCONNECT, PLACED ON THE OUTSIDE OF THE COVER WHEN DISCONNECT IS OPERABLE WITH SERVICE PANEL CLOSED. (PER CODE: CEC690.12, 690.56(C))

**PHOTOVOLTAIC SYSTEM AC DISCONNECT**  
 RATED AC OPERATING CURRENT 33.88 AMPS  
 AC NOMINAL OPERATING VOLTAGE 240 VOLTS

LABEL LOCATION:  
 AC DISCONNECT, INVERTER  
 (PER CODE: CEC690.53)

**CAUTION**  
**DUAL POWER SOURCE**  
 SECOND SOURCE IS PV SYSTEM

CEC 705.12(D)(4) - AT MAIN SERVICE PANEL

**AC SYSTEM DISCONNECT FOR UTILITY OPERATION**

LABEL LOCATION:  
 UTILITY DISCONNECT

**WARNING: PHOTOVOLTAIC POWER SOURCE**

LABEL LOCATION:  
 INVERTER, JUNCTION BOXES (ROOF), AC DISCONNECT  
 (PER CODE: CEC690.13 & CEC 690.13)

**WARNING - Electric Shock Hazard**  
 No user serviceable parts inside  
 Contact authorized service provider for assistance

LABEL LOCATION:  
 INVERTER, JUNCTION BOXES (ROOF), AC DISCONNECT  
 (PER CODE: CEC690.13 & CEC 690.13)

**WARNING**  
**ELECTRIC SHOCK HAZARD**  
 DO NOT TOUCH TERMINALS  
 TERMINALS ON BOTH LINE AND LOAD SIDES MAY BE ENERGIZED IN THE OPEN POSITION  
 DC VOLTAGE IS ALWAYS PRESENT WHEN SOLAR MODULES ARE EXPOSED TO SUNLIGHT

LABEL LOCATION:  
 DC DISCONNECT, INVERTER  
 (PER CODE: CEC 690.17(B))  
 [To be used when inverter is ungrounded]

NEC 690.56(C) - MAIN SERVICE PANEL/AC DISCONNECT

**SOLAR PV SYSTEM EQUIPPED WITH RAPID SHUTDOWN**

TURN RAPID SHUTDOWN SWITCH TO THE "OFF" POSITION TO SHUTDOWN PV SYSTEM AND REDUCE SHOCK HAZARD IN ARRAY

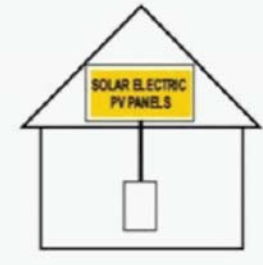
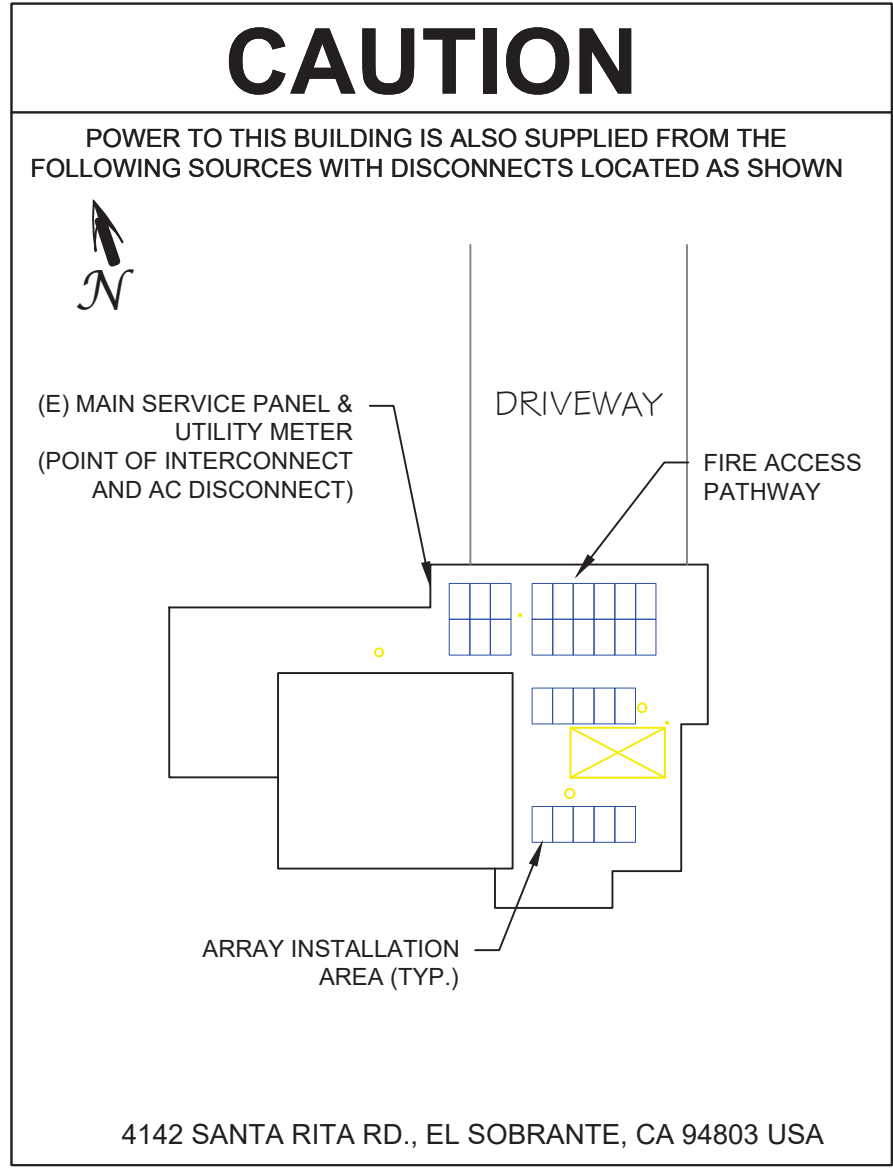
REVISIONS	DESCRIPTION	DATE	REV
	100% DESIGN	25-JUL-22	01
	CLIENT COMMENTS	02-AUG-22	02
	CLIENT COMMENTS	12-SEP-22	03
	CLIENT COMMENTS	27-OCT-22	04
	MODULE CHANGED	03-FEB-23	05

Signature with Seal

CUSTOMER INFORMATION

**APRIL BELL**  
 4142 SANTA RITA RD.,  
 EL SOBRANTE, CA 94803 USA  
 JURISDICTION: CONTRA COSTA, COUNTY OF

SHEET NAME  
**LABELS & PLACARD**

SHEET SIZE  
**ANSI B  
 11" X 17"**

SHEET NUMBER  
**PV-5**





**Simplified Grounding for Every Application**

The UFO family of components eliminates the need for separate grounding hardware by bonding solar modules directly to IronRidge XR Rails. All system types that feature the UFO family—Flush Mount, Tilt Mount and Ground Mount—are fully listed to the UL 2703 standard.

UFO hardware forms secure electrical bonds with both the module and the rail, resulting in many parallel grounding paths throughout the system. This leads to safer and more reliable installations.

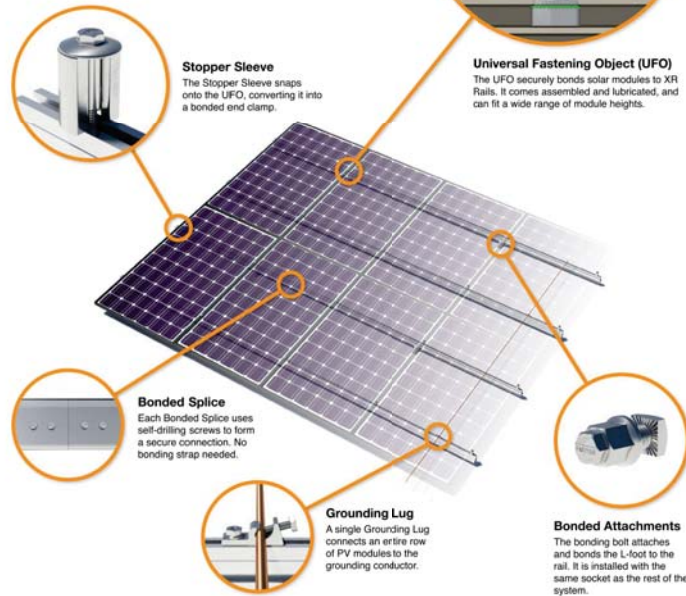

**System Diagram**

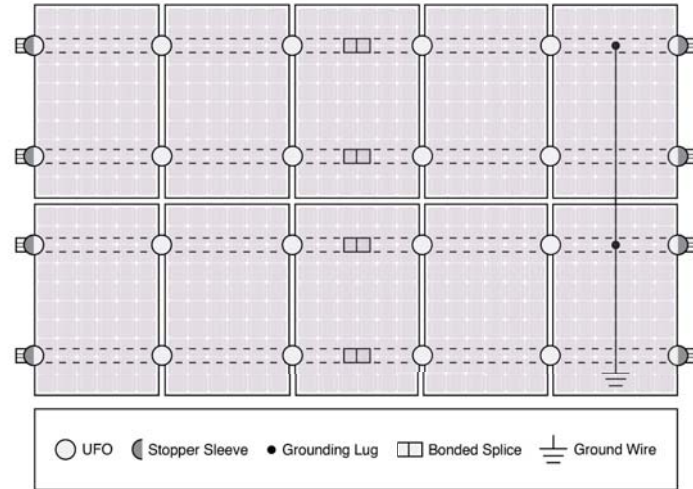

Approved Enphase microinverters can provide equipment grounding of IronRidge systems, eliminating the need for grounding lugs and field installed equipment ground conductors (EGC). A minimum of two microinverters mounted to the same rail and connected to the same Engage cable is required. Refer to installation manuals for additional details.

**UL Certification**

The IronRidge Flush Mount, Tilt Mount, and Ground Mount Systems have been listed to UL 2703 by Intertek Group plc.

UL 2703 is the standard for evaluating solar mounting systems. It ensures these devices will maintain strong electrical and mechanical connections over an extended period of time in extreme outdoor environments.

Go to [IronRidge.com/UFO](http://IronRidge.com/UFO)

Cross-System Compatibility			
Feature	Flush Mount	Tilt Mount	Ground Mount
XR Rails	✓	✓	XR1000 Only
UFO/Stopper	✓	✓	✓
Bonded Splice	✓	✓	N/A
Grounding Lugs	1 per Row	1 per Row	1 per Array
Microinverters & Power Optimizers	Enphase - M250-72, M250-60, M215-60, C250-72 Darfon - MIG240, MIG300, G320, G640 SolarEdge - P300, P320, P400, P405, P600, P700, P730		
Fire Rating	Class A	Class A	N/A
Modules	Tested or Evaluated with over 400 Framed Modules Refer to installation manuals for a detailed list.		



**Trust your system at every angle.**

The IronRidge Tilt Mount System supports a wide range of solar module tilting angles, while also resisting the extreme wind and snow forces experienced over a building's lifetime.

Every component has been carefully engineered and rigorously tested, and the entire system uses only aluminum and stainless steel materials to resist corrosion.

- Roof Friendly**  
Lightweight and compatible with industry-standard attachments.
- Strength Tested**  
All components evaluated for superior structural performance.
- UL 2703 Listed System**  
Meets newest effective UL 2703 standard.
- PE Certified**  
Pre-stamped engineering letters available in most states.
- Design Assistant**  
Online software makes it simple to create, share, and price projects.
- 25-Year Warranty**  
Products guaranteed to be free of impairing defects.

REVISIONS	REV	DATE	DESCRIPTION
	01	25-JUL-22	100% DESIGN
	02	02-AUG-22	CLIENT COMMENTS
	03	12-SEP-22	CLIENT COMMENTS
	04	27-OCT-22	CLIENT COMMENTS
	05	03-FEB-23	MODULE CHANGED

Signature with Seal

**CUSTOMER INFORMATION**

**APRIL BELL**  
4142 SANTA RITA RD.,  
EL SOBRANTE, CA 94803 USA  
JURISDICTION: CONTRA COSTA, COUNTY OF

SHEET NAME  
**EQUIPMENT SPECIFICATION-2**

SHEET SIZE  
**ANSI B  
11" X 17"**

SHEET NUMBER  
**PV-6.2**

**XR Rails & Tilt Legs**



**Grounding Clamps**



**Accessories**



**Resources**

**Design Assistant**  
Go from rough layout to fully engineered system. For free. Go to [IronRidge.com/design](http://IronRidge.com/design)

**NABCEP Certified Training**  
Earn free continuing education credits, while learning more about our systems. Go to [IronRidge.com/training](http://IronRidge.com/training)

**Solar Is Not Always Sunny**

Over their lifetime, solar panels experience countless extreme weather events. Not just the worst storms in years, but the worst storms in 40 years. High winds capable of ripping panels from a roof, and snowfalls weighing enough to buckle a panel frame.

XR Rails are the structural backbone preventing these results. They resist uplift, protect against buckling and safely and efficiently transfer loads into the building structure. Their superior spanning capability requires fewer roof attachments, reducing the number of roof penetrations and the amount of installation time.

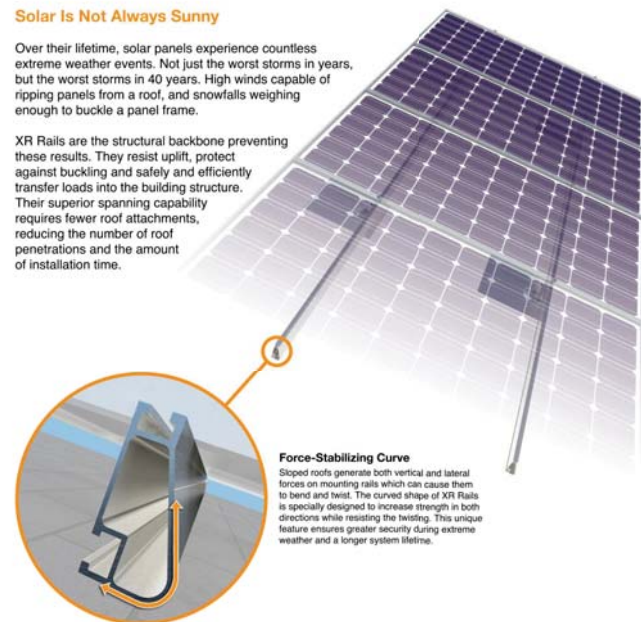

**Compatible with Flat & Pitched Roofs**  
XR Rails are compatible with FlashFoot and other pitched roof attachments.

**Corrosion-Resistant Materials**  
All XR Rails are made of 6000-series aluminum alloy then protected with an anodized finish. Anodizing prevents surface and structural corrosion, while also providing a more attractive appearance.

**XR Rail Family**

The XR Rail Family offers the strength of a curved rail in three targeted sizes. Each size supports specific design loads, while minimizing material costs. Depending on your location, there is an XR Rail to match.



**Rail Selection**

The following table was prepared in compliance with applicable engineering codes and standards. Values are based on the following criteria: ASCE 7-10, Roof Zone 1, Exposure B, Roof Slope of 7 to 27 degrees and Mean Building Height of 30 ft. Visit [IronRidge.com](http://IronRidge.com) for detailed open tables and certifications.

Snow (PSF)	Wind (MPH)	Rail Span					
		4'	5'-5"	6'	8'	10'	12'
None	100						
	120						
	140	XR10		XR100		XR1000	
10-20	100						
	120						
	140						
30	100						
	160						
40	100						
	160						
50-70	100						
	160						
80-90	100						
	160						

NOTES:  
 1. ATTACHMENT CAN ACCOMMODATE ROOFING SCREW SIZES #12 - #15. FASTENER SIZE, LENGTH, AND QUANTITY TO BE SELECTED BY STRUCTURAL ENGINEER OF RECORD WHEN DESIGNING FOR THE SPECIFIC PROJECT CONSTRUCTION AND CAPACITY.  
 2. REFER TO THE UNIRAC INSTALLATION GUIDE FOR PROPER USE OF CHEM LINK M1 AND ONE-PART SEALANTS FOR WATER TIGHT INSTALLATION.

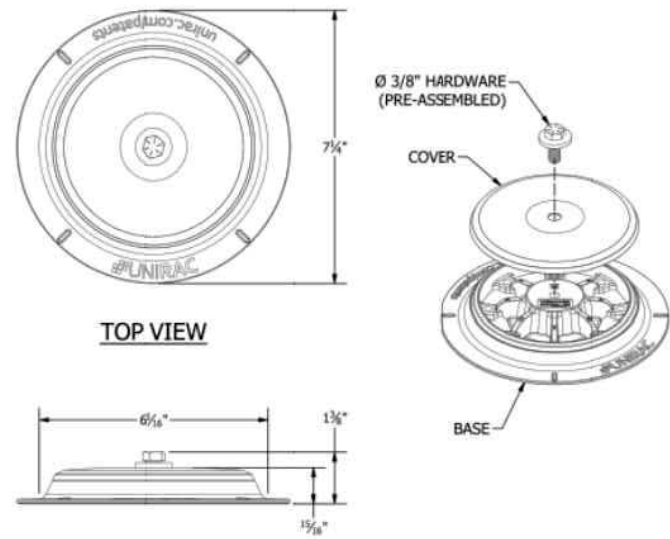

PART # TABLE		ULTIMATE TEST LOAD (WITH 8 ROOF FASTENERS)	
P/N	DESCRIPTION	UPLIFT ULTIMATE CAPACITY	SHEAR ULTIMATE CAPACITY
310999	FLASHLOC RM KIT	6,670 lbs.	5,760 lbs.

<p>1111 BROADWAY BLVD. NE          ALBUQUERQUE, NM 87102 USA          PHONE: 505.242.6411          WWW.UNIRAC.COM</p>	PRODUCT LINE: RM	DRAWING NOT TO SCALE ALL DIMENSIONS ARE NOMINAL	RMF-A01 SHEET
	DRAWING TYPE: ASSEMBLY DETAIL	PRODUCT PROTECTED BY ONE OR MORE US PATENTS	
	DESCRIPTION: FLASHLOC RM KIT	LEGAL NOTICE	
	REVISION DATE: 6/26/2020		

## FLASHLOC™ RM

THE STRONGEST ATTACHMENT FOR EVERY FLAT ROOF



Unirac's **FLASHLOC™ RM** is a lightweight, durable, powder-coated cast aluminum roof attachment solution that provides fast, easy installation and helps save labor cost. **FLASHLOC™ RM** is compatible with most roofing materials and is applicable for almost all solar racking form factors. Rigorous mechanical, sealing, and ease-of-install testing has been successfully completed for assurance of long-term reliability.

### FEATURES

- FLASHLOC™ Technology** – no membrane SKUs or heat welding
- Works for all roof types – see Chemlink M-1's compatibility for details
  - Labor and attachment savings
  - Industry-leading install time
  - 6,600-lb. uplift offset (ultimate)
  - Includes 8 fastener holes
  - Attachment can accommodate roofing screw sizes #12 - #15
  - 25-year warranty

### PRODUCT SPECIFICATIONS

- 7.5" diameter X 0.94" height
- Included hardware: 1 preassembled bolt and washer
- Chemlink M-1 and 1-Part included in kit

PART NUMBER	DESCRIPTION	PACK SIZE
310999	FLASHLOC RM KIT	10

\*Check with your local distributor for finalized pricing.



## FLASHLOC™ RM

INSTALLATION GUIDE



### STEP ONE CLEAN SURFACE AND MARK LOCATION

-IMPORTANT: Thoroughly clean roof surface with isopropyl alcohol or denatured alcohol. Bonding surfaces should be clean, dry and free of dirt or contamination. Remove all previously applied caulk, mastic or other contaminants with a wire brush. Brush away all gravel or loose granules.

-Mark center point locations on the roof. NOTE: We recommend locating Flashloc RM after your equipment has been installed or layout is confirmed.

### STEP TWO APPLY M1 SEALANT

-Apply a 5/16" bead of Chemlink M1 sealant to the entire bottom perimeter AND to the bottom of each bolt location to be used. Tool M1 sealant bead to form a smooth surface along the entire bottom perimeter. Refer to Chemlinks application guidelines with temperatures below 40 degrees F.

-IMPORTANT: CHEMLINK TPO PRIMER MUST BE USED ON TPO SINGLE-PLY ROOF SUBSTRATES MEMBRANES PRIOR TO INSTALLATION.

### STEP THREE SECURE ATTACHMENT

-Align mount using alignment marks on roof and base. Using fasteners specified by your P.E. of record, securely fasten attachment to the roof. Drive screws down until the base is firmly attached to the roof and the M1 sealant expands beyond the outer perimeter of the base.

-Tool M1 sealant bead around entire perimeter to form a smooth fillet. TIP: Use caution to avoid over-torquing the screws.

### STEP FOUR FILL BASE WITH CHEMLINK 1-PART

-Completely fill base with Chemlink 1-Part sealant. Sealant must completely cover all screw heads. Do NOT overfill.

-Place cap on base and secure racking to mount with Unirac provided 3/8" hardware or other 3/8"-16 threaded hardware as specified by the P.E. of record.

-IMPORTANT: To ensure robust sealing over the life of the product, the maximum allowed gap between attachment kit strut and the top surface of the flat roof attachment is 1/16".

**FASTER INSTALLATION. 25-YEAR WARRANTY.**

FOR QUESTIONS OR CUSTOMER SERVICE VISIT UNIRAC.COM OR CALL (505) 248-2702

**FASTER INSTALLATION. 25-YEAR WARRANTY.**

FOR QUESTIONS OR CUSTOMER SERVICE VISIT UNIRAC.COM OR CALL (505) 248-2702

## SOLAR PANEL MOUNT

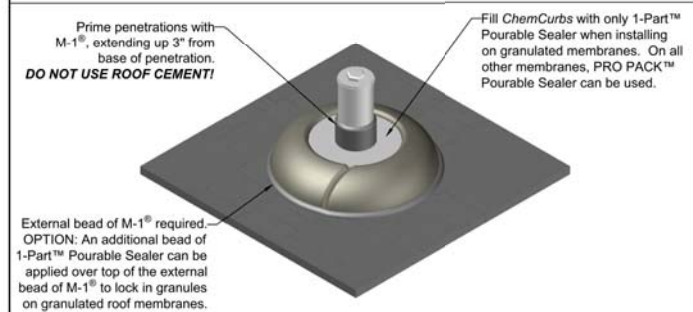
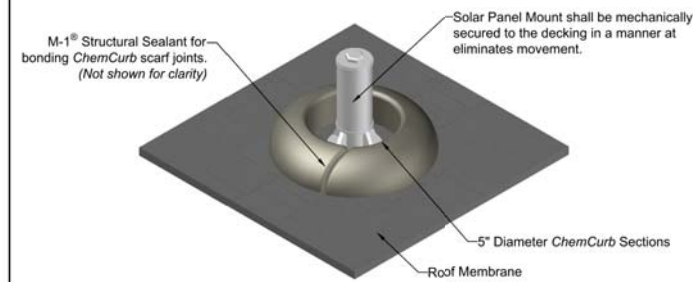

A minimum 1" space is required between all penetrations and the interior wall of all ChemCurbs.



CONTACT INFORMATION: Customer Service: 800.826.1681  
 www.ChemLink.com

© May 12, 2013 ChemCurbs Sheet 9 of 16 UNIRAC CL-CC-02 Drawn by Christian Appold

REVISIONS	REV	DATE	DESCRIPTION
	01	25-JUL-22	100% DESIGN
	02	02-AUG-22	CLIENT COMMENTS
	03	12-SEP-22	CLIENT COMMENTS
	04	27-OCT-22	CLIENT COMMENTS
	05	03-FEB-23	MODULE CHANGED

Signature with Seal

### CUSTOMER INFORMATION

**APRIL BELL**

4142 SANTA RITA RD.,  
 EL SOBRANTE, CA 94803 USA  
 JURISDICTION: CONTRA COSTA, COUNTY OF

SHEET NAME  
**EQUIPMENT SPECIFICATION-3**

SHEET SIZE  
**ANSI B  
 11" X 17"**

SHEET NUMBER  
**PV-6.3**